

A photograph of the Hotel Miramar in Barcelona, a grand, light-colored building with classical architectural features like arches and columns. The name 'HOTEL MIRAMAR' is displayed in large, illuminated letters on the roof. In the foreground, there are stone steps leading up to the entrance, decorated with numerous potted plants. The sky is clear and blue.

HOTEL MIRAMAR

HOTEL MIRAMAR BARCELONA 5★



Access for the disabled
 Business Center
 Free Wi-Fi
 Fitness room
 Parking
 Transfer options

15 from airport (16km)
 10 minutes from Paral·lel subway (walking)
 15 minutes from Las Ramblas (walking)
 5 minutes from Fira Barcelona (by car)
 10 minutes from Fira Gran Vía (by car)
 10 minutes from CCIB (by car)

NEARBY PLACES OF INTEREST

Cable car to the beach 1 minute
 National Museum of Art of Catalunya
 Palau Sant Jordi (Olympic Stadium)
 Miró Fundation



75 ROOMS



**35 DELUXE ROOMS
27 M2**



**32 PREMIUM ROOMS
35 M2**





75 ROOMS



7 SUITES
45 M2



1 GRAN SUITE
MEDITERRÁNEA
70 M2



STUDIO MIRAMAR



STUDIO MIRAMAR RESTAURANT

128 m²

CAPACITY

80 persons



LOBBY



- LOBBY -

HISTORIC FACADE

PIGMENT GALLERY

PREFUNCTION AZULETE

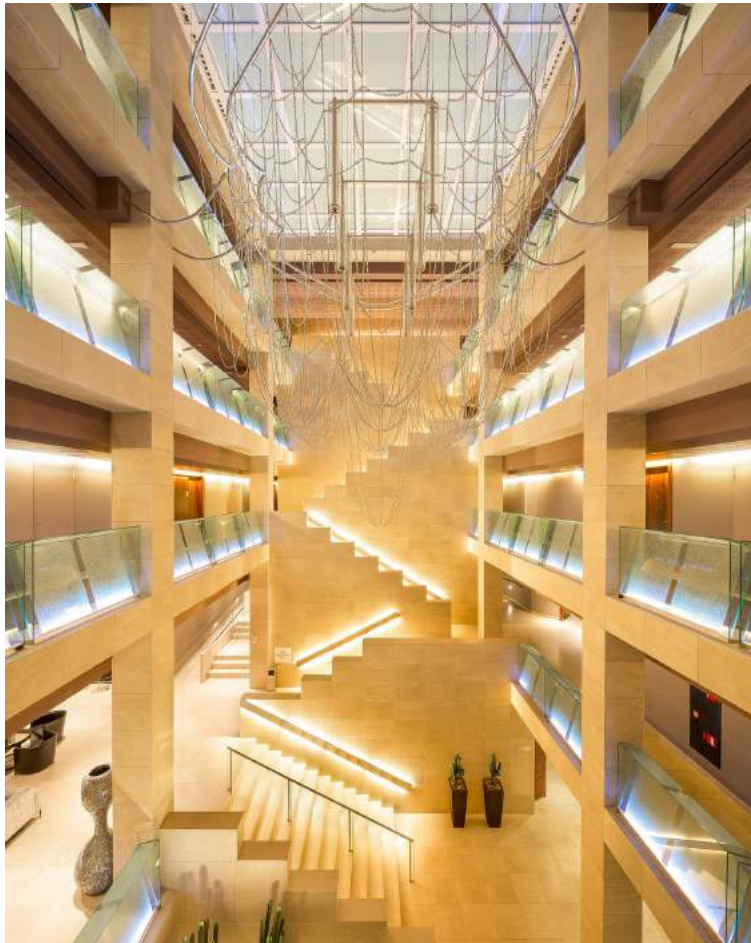

WELLNESS & SPA



SPA BY L'OCCHITANE



OUTDOOR POOL



WELLNESS



MEDITERRÁNEO MEETING ROOM



DIMENSIONS

300m²



CAPACITY

Banquet: 250 persons

Cocktail: 250 persons

Buffet: 160 persons



OUTDOOR SPACES

Beautiful garden

ideal for parties by the pool. *

(summer time, from 7 pm)



SOCIAL EVENTS

CORPORATE EVENTS



CAPACITY

Theater: 240 persons

School: 156 persons

Imperial: 80 persons

Cabaret: 120 persons

U: 45 persons



300 m²

EXCLUSIVE USE

AZULETE MEETING ROOM



DIMENSIONS

300m²



CAPACITY

Banquet: 180 persons

Cocktail: 200 persons

Buffet: 120 personas



Theater: 180 persons

School: 120 persons

Imperial: 50 persons

Cabaret: 90 persons

U: 40 persons



CELLER

MONTJUÏC MEETING ROOM



DIMENSIONS

166 m²



CAPACITY

Theater: 140 pax

Banquet: 100 pax

School: 100 pax

Cocktail: 120 pax

Imperial: 45 pax

Buffet: 80 pax

Cabaret: 70 pax

U: 40 pax



FÓRUM A - B



DIMENSIONS

Fórum A - 34 m²

Fórum B - 32 m²

CAPACITY

Theater: 24 persons

School: 18 persons

Imperial: 18 persons

Cabaret: 12 persons

Banquet: 20 persons

U: 18 persons



CONSELL A/B



DIMENSIONS

Consell A - 24 m²

Imperial: 10 persons

Cabaret: 6 persons

Banquet: 10 persons

U: 8 persons

Consell B - 40 m²

Theater: 28 persons

School: 22 persons

Imperial: 20 persons

Cabaret: 15 persons

U: 18 persons



TIPUANAS TERRACE



DIMENSIONS

500 m²



CAPACITY

Banquet: 300 persons

Cocktail: 300 persons

Buffet: 200 persons

NARANJOS TERRACE



DIMENSIONS

495 m2

CAPACITY

Banquet: 250 persons

Cocktail: 250 persons

Buffet: 150 persons



¡WE WILL WAIT
FOR YOU!

WWW.HOTELMIRAMARBARCELONA.COM

